

CLAMP-ON TYPE PRECISION AC CURRENT SENSOR

MODEL
CTB



■FEATURES

- Accuracy 0.2%F.S.
- Clamp-on type CT, connector easy
- Dielectric strength 2KVac/1min. (input/output)
- 1.2x50us)(Impuse test 5KV(1.2x50us)(IEC255-4,ANSI C37.90a/1974
- 0.25ms/1MHz)(Surge test (ring wave)2.5KV(0.25ms/1MHz)(IEC255-4
- Low cost and dimension small and High stability

1.MODEL:CTB-□ □

NO	Current Input/Output Range (Max.Load)	NO	Output Cable Length
1	AC0~60A/0~20mA(<50 ohm)	1	1.8M
2	AC0~120A/0~40mA(<25 ohm)	9	Customer
3	AC0~600A/0~200mA(<5 ohm)		

2.SPCIFICATION

- Measuring accuracy : 0.2% F.S.(25±15°C)
- Maximum input over : Current related input: 3 x rated continuous
10 x rated 30 sec. 25 x rated 3 sec.
50 x rated 1 sec.
- Input frequency range : 20Hz~400Hz
- Maximum output burden : <1VA
- Temp. coefficient : 25ppm/°C (25±35°C)
- Insulation resistance : >100M ohm with 500Vdc
- Dielectric strength : 2KVac/1 min. (input/output)
- Impulse test : ANSI C37.90a/1974,DIN-IEC 255-4
impulse voltage 5KV(1.2x50us)
- Surge test (ring wave) : 2.5KV-0.25ms/1MHz(IEC255-4)
- RFI protection : 2W-150MHz at 2 meter causes less
than 0.5% change in output
- Operating condition : -20~75°C (20 to 90% RH non-condensed)
- Storage condition : -30~90°C (20 to 90% RH non-condensed)
- Case materials : PBT(UL94-VO)
- CE EMC Certification : EN 55022:1998/A1:2000 Class A
EN 61000-3-2:2000
EN 61000-3-3:1995/A1:2001
EN 55024:1998/A1:2001

3.TERMINAL CONNECTION

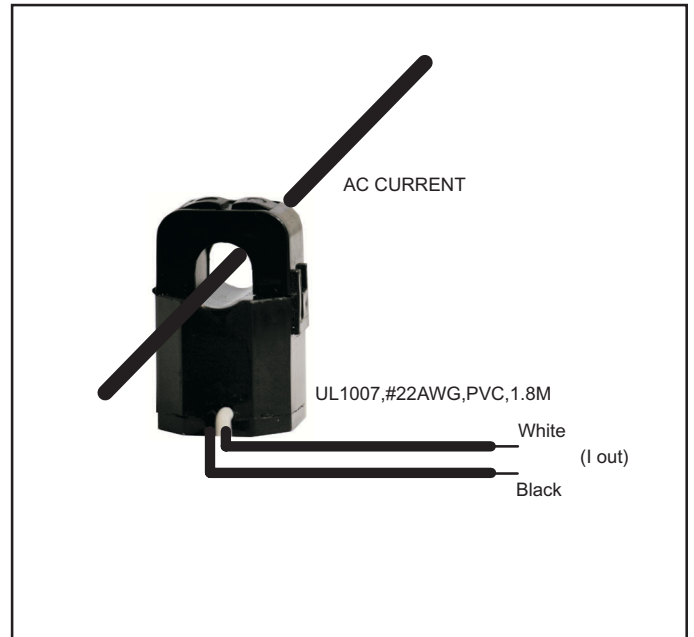

4.DIMENSION (unit:mm)

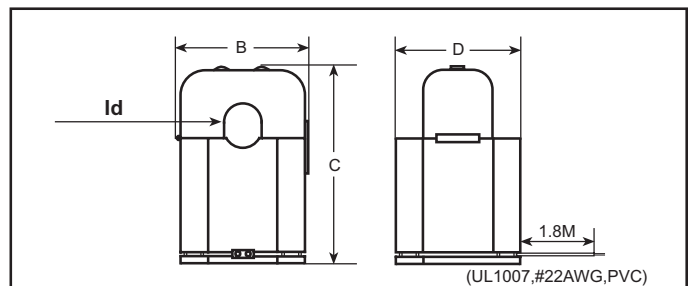

MODEL	Id(max.)	B(max.)	C(max.)	D(max.)
CTB-1	10.75	25.5	39.2	26.5
CTB-2	16.00	31.4	44.6	31.0
CTB-3	35.70	57.0	81.5	38.4